

# HOW TO INSTALL NYLON SPACERS USING 2 x 13mmW SLIDES



## BEFORE YOU BEGIN

- Place nylon spacers, slides and basket into position to ensure you have the correct fit and the slides clear the door obstruction.
- A small gap (up to 5mm) is fine if you are using slides with hooks (product code SL.450 or SLB.450).
- These instructions are applicable if packing out using 4mm (1 x 4mm), 8mm (2 x 4mm), or 12mm (3 x 4mm) white nylon spacers.
- The standard screws supplied with basket are 16mm length. Depending on the spacer thickness, we suggest:
  - If using 4mm spacer, 8G x 16mm counter, phillips head countersunk or pan head
  - If using 8mm spacer, 8G x 20mm counter, phillips head countersunk or pan head
  - If using 12mm spacer, 8G x 25mm counter, phillips head countersunk or pan head

## SPACER PLACEMENT

- Spacers can be used on one side or both.
- They are placed between the cabinet wall and slide.
- 4mm nylon spacers can be used in the following combinations:
  - 4mm (1 x 4mm spacer)
  - 8mm (2 x 4mm spacers)
  - 12mm (3 x 4mm spacers)
 If you are using 3 x 4mm, we recommend a batten for increased strength.
- You will need to place spacers in 3 locations

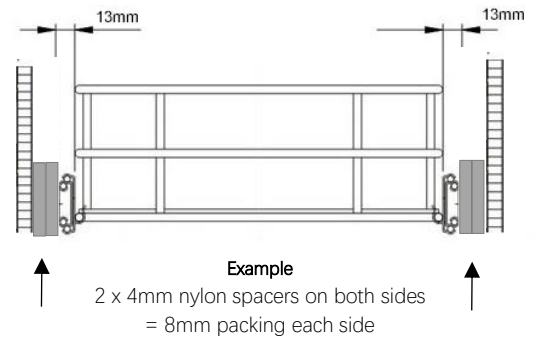

1 x 4mm nylon spacer  
= 4mm packing

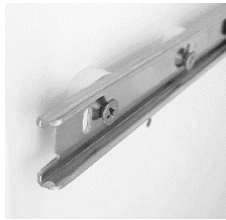

2 x 4mm nylon spacer  
= 8mm packing



3 x 4mm nylon spacer  
= 12mm packing  
A batten is best option  
for baskets 500mm+



## HOW MANY SPACERS DO I NEED?

Amount of Packing	One Side	Both Sides
4mm	3 spacers required	6 spacers required
8mm	6 spacers required	12 spacers required
12mm	9 spacers required	18 spacers required

## STEP BY STEP INSTALLATION INSTRUCTIONS

### STEP 1: SEPARATE SLIDE MEMBERS

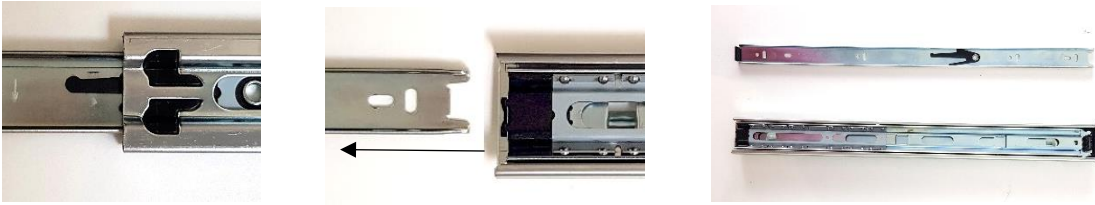

Turn the slides over & extend them fully until you can see the black disconnect lever. Pinch it in the direction of the arrow. This will release the slide members.

### STEP 2: INSTALL SPACER AND SLIDE MEMBER

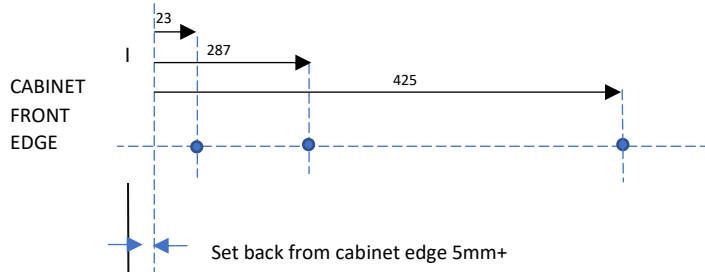

- Recommended set back from cabinet edge is 5mm+. The closer to the front edge of the cabinet the better, unless you have spice racks on the door.
- Mark your holes on the cabinet wall with your desired set back.
- Drill holes and check that slide holes line up.
- Screw your slide member and nylon spacer to the cabinet wall using the appropriate length screw. NOTE: Ensure your screw is 8G or less, otherwise they will prevent the slide working correctly.

### STEP 3: RE-CONNECT THE SLIDE MEMBERS



A. Ensure the ball bearings are slid forward before reconnecting.

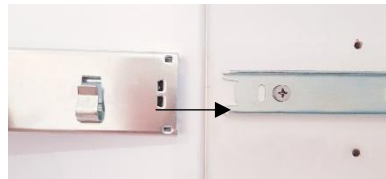

B. Turn the outer slide member over and connect to the inner member that is installed to the cabinet wall.



C. Your slide and spacer combination should clear your door obstruction.

Move slides in/out to ensure they are operating smoothly.

### TROUBLE SHOOTING

#### Slides feel tight when pulling in/out.

- Check that you are using the correct screw type. If the screw head protrudes too much it will stop the slides operating smoothly. Ensure you are using 8G and/or panhead screw.
- Check that the slide members are correctly re-connected. Use the disconnect lever and re-connect again (follow step 4).

#### Slides are stuck behind the cabinet door

You require a thicker spacer or batten but if it's stuck by just a few millimetres we suggest using washers from the hardware store or use additional 4mm spacers.

Thank you for choosing Tansel.